

**929
BROADWAY**
DENVER, CO 80209



**929
BROADWAY**

NOW AVAILABLE
929 BROADWAY :: DENVER, CO 80209

- Building SF: 21,350 SF on two floors
- Lease Rate: \$20.50/RSF modified gross
- TI Allowance: Negotiable
- Parking: 3:1,000
Underground secured: \$100/mo.
Surface parking: \$75/mo.



FOR MORE INFORMATION CONTACT:

Joe Serieno

Senior Vice President
303.628.1702
joe.serieno@cbre.com

Hadley Cox

Senior Associate
T 303.628.1774
hadley.cox@cbre.com



CB Richard Ellis | 1225 17th Street | Suite 2950 | Denver, CO 80202 | www.cbre.com/denver

©2010 CB Richard Ellis, Inc. The information above has been obtained from sources believed reliable. While we do not doubt its accuracy, we have not verified it and make no guarantee, warranty or representation about it. It is your responsibility to independently confirm its accuracy and completeness.

FOR MORE INFORMATION CONTACT:

Joe Serieno

Senior Vice President
303.628.1702
joe.serieno@cbre.com

Hadley Cox

Senior Associate
T 303.628.1774
hadley.cox@cbre.com



929 BROADWAY

FEATURES

- Amenities: Men's and women's shower facilities, large kitchen/break area, spacious training room, secured storage on lower level, glass encased conference rooms, private entrance
- High visibility building
- Broadway signage available
- Building naming rights
- Located in the heart of the Golden Triangle
- Excellent access to CBD and I-25
- Numerous restaurants within easy walking distance
- Reserved parking
- Tenant control of HVAC
- Tenant control of building hours of operation

LOCAL RESTAURANTS



SECOND FLOOR

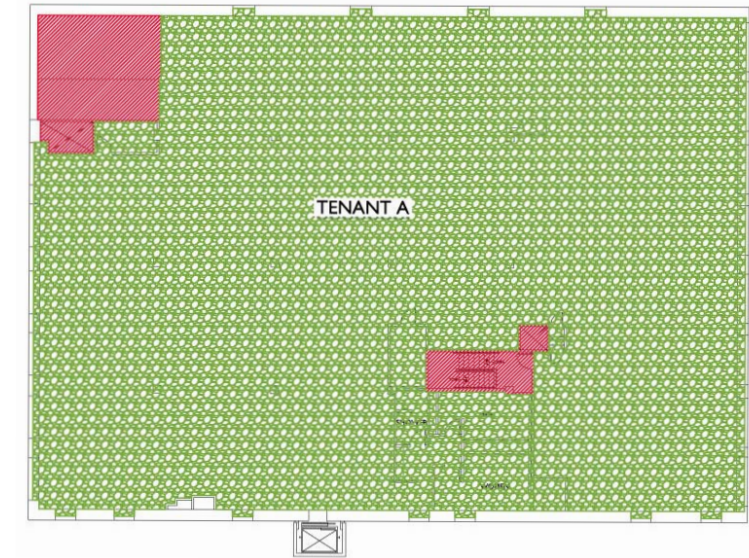

MEZZANINE

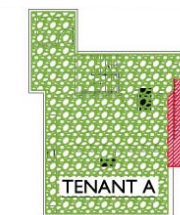

FIRST FLOOR

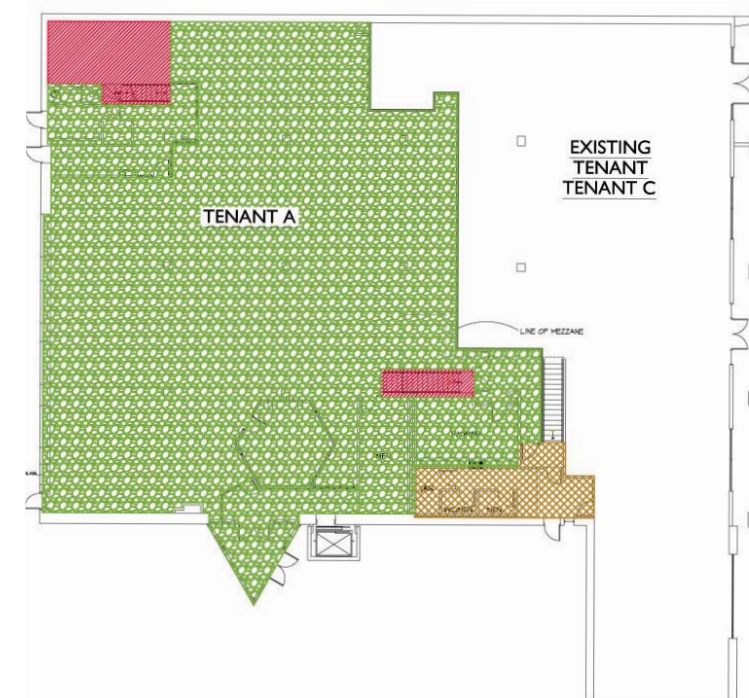

- EXISTING TENANT C
- TENANT A
- TENANT B
- CA (COMMON AREA)
- BCA (BUILDING COMMON AREA)
- MVP (MAJOR VERTICAL PENETRATIONS)