

OFFICE SPACE
AVAILABLE

2410 SE 11TH & CARUTHERS

PORTLAND, OREGON



AVAILABILITY

:: Office: ± 5,550 SF (See reverse side)

RENT

:: Office: \$7,862 per month (less janitorial)

AMENITIES

:: Close-in SE location



FOR MORE
INFORMATION
PLEASE
CONTACT

Rich Sabel

503.221.4864

rich.sabel@cbre.com

www.cbre.com/rich.sabel

CBRE
CB RICHARD ELLIS

OFFICE SPACE
AVAILABLE

2410

SE 11TH & CARUTHERS

PORTLAND, OREGON

SITE PLAN

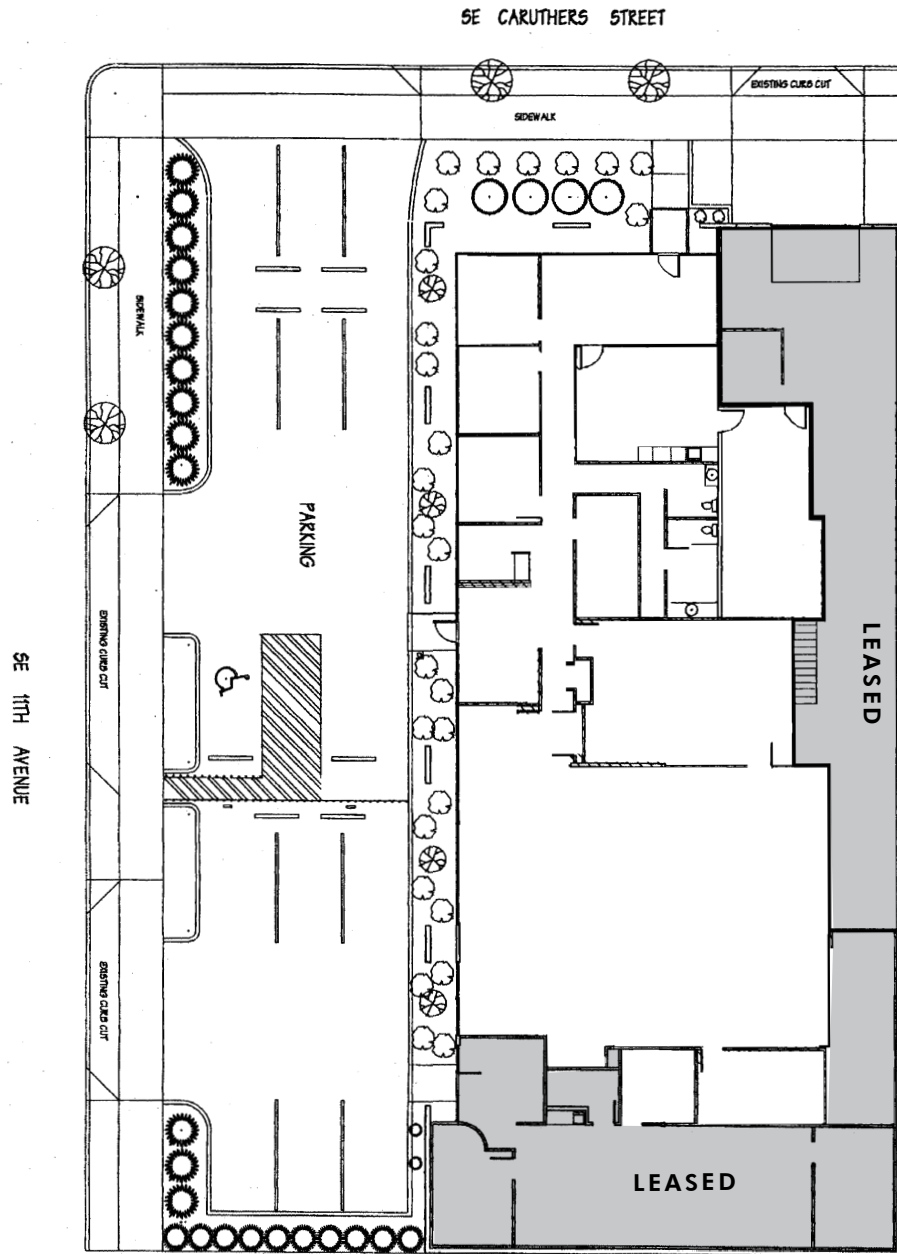

FOR MORE
INFORMATION
PLEASE
CONTACT

Rich Sabel

503.221.4864

rich.sabel@cbre.com

www.cbre.com/rich.sabel

CB Richard Ellis | 1300 SW Fifth Avenue | Suite 3000 | Portland, OR 97201 | www.cbre.com/portland

© 2010 CB Richard Ellis, Inc. This information has been obtained from sources believed reliable. We have not verified it and make no guarantee, warranty or representation about it. Any projections, opinions, assumptions or estimates used are for example only and do not represent the current or future performance of the property. You and your advisors should conduct a careful, independent investigation of the property to determine to your satisfaction the suitability of the property for your needs.

CBRE
CB RICHARD ELLIS